

FOR SIDE SEAM ABUTMENT,
SEE DETAIL 7/1

EXTEND BLANKET A MINIMUM OF 3'-0"
OVER CREST OF SLOPE. SEE DETAIL 4/1.
TRENCHING NEEDED IF A MINIMUM
OF 3'-0" IS NOT AVAILABLE AT THE
CREST OF SLOPE OR IF OVERLAND
FLOW IS ANTICIPATED FROM UPLAND
AREAS. SEE DETAILS 5/1 & 6/1

FOR END ROLL
OVERLAP, SEE
DETAIL 2/1

OPTIONAL SIDE SEAM OVERLAP,
SEE DETAIL 8/1

BLANKET TO EXTEND A MINIMUM OF
3'-0" BEYOND TOE OF SLOPE. FOR
BOTTOM OF SLOPE TERMINATION,
SEE DETAIL 3/1.
IF INSTALLATION 3' BEYOND TOE OF
SLOPE IS NOT POSSIBLE,
SEE DETAIL 9/1

SLOPE DETAIL
NO SCALE

END SEAM OF BLANKETS OVERLAP 2"-4".
PLACE STAPLES, ONE ON EACH CORNER
OF BLANKET, 12" O.C. ALONG BLANKET
END THROUGH BOTH BLANKETS. UPSLOPE
BLANKET LAPS OVER DOWNSLOPE
BLANKETS IN A SHINGLE AFFECT.

3'-0" MIN.

STAPLE 12" O.C. ALONG
BOTTOM OF BLANKET
AT THE END OF SLOPE

STAPLE 12" O.C. ALONG
BLANKET AT SLOPE
CHANGE

END ROLL OVERLAP
NO SCALE

**BOTTOM OF SLOPE TERMINATION IF
INSTALLED 3' BEYOND THE TOE OF SLOPE**
NO SCALE

Curlex® Staple Pattern Guide

For 8 ft wide Curlex Erosion Control Blankets

Adjust horizontal staple spacing for 4 ft and 16 ft wide Curlex Erosion Control Blankets

Application	Slope		
	≤ 4H:1V	≤ 3H:1V	≤ 5H:1V
Staple Pattern	A	B	C

● = Staple Placement

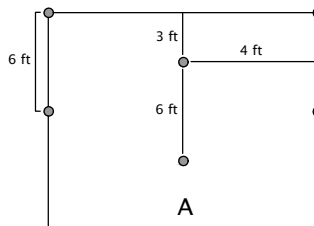

0.6 Staples/yd²

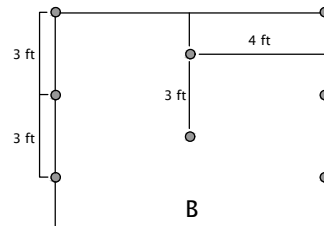

1.1 Staples/yd²

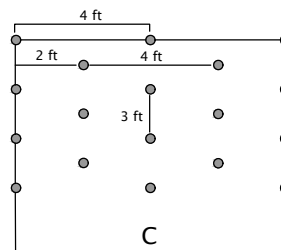

1.9 Staples/yd²

Notes:

1. Recommended staples are minimum 4 in biodegradable E-Staple®, as provided by American Excelsior Company, or 6 in wire for cohesive soils and 6 in biodegradable E-staple®, as provided by American Excelsior Company, or 8 in wire for non-cohesive soils.
2. For best results insert staples so heads are parallel to the flow of water.
3. For additional pull-out resistance, consider using TL-TA2 Gripple twist anchors for tough/cohesive soils or TL-TA1 Gripple twist anchors for moderate/non-cohesive soils.

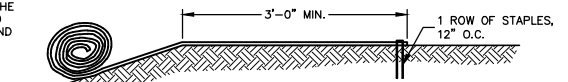

**OVER SLOPE
CREST METHOD**

NO SCALE

DO NOT NEED TO TRENCH BLANKET IN IF
IT CAN BE EXTENDED A MINIMUM OF 3'-0"
OVER THE CREST OF THE SLOPE.

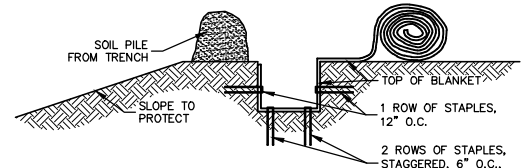

STEP 1

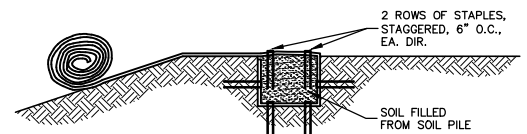

STEP 2

**SLOPE TRENCHING
METHOD 'A'**

NO SCALE

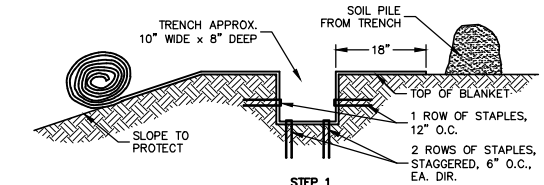

STEP 1

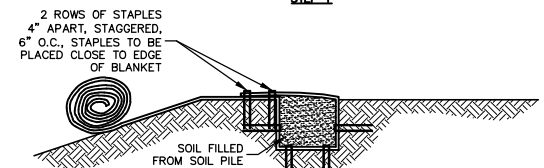

STEP 2

**SLOPE TRENCHING
METHOD 'B'**

NO SCALE

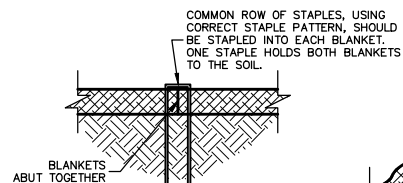

**SIDE SEAM ABUT
STAPLE DETAIL**

NO SCALE

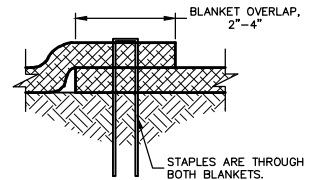

**SIDE SEAM OVERLAP
STAPLE DETAIL**

NO SCALE

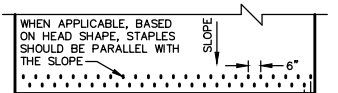

**BOTTOM OF SLOPE TERMINATION
IF INSTALLATION 3' BEYOND TOE
OF SLOPE IS NOT POSSIBLE**

NO SCALE

AMERICAN EXCELSIOR COMPANY
ARLINGTON, TEXAS

SHEET DESCRIPTION
**CURLEX® SLOPE
APPLICATION DETAIL**

DATE 11/22/23
SCALE
NONE

DRAWN BY
PROJECT NO.
SHEET NO.
1

**American
Excelsior
Company®**
Earth Science Division