

DO NOT NEED TO TRENCH TRM IN IF IT CAN BE EXTENDED A MINIMUM OF 3'-0" OVER THE CREST OF THE SLOPE.

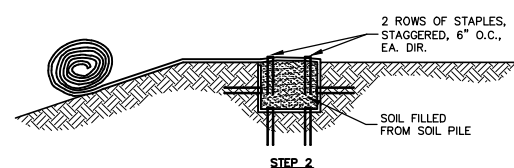
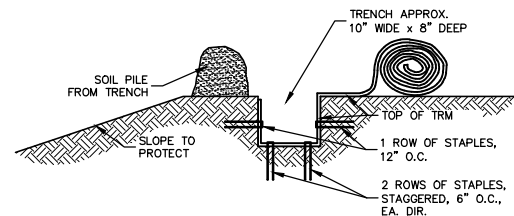

**SLOPE TRENCHING METHOD "A"**

NO SCALE

5  
5

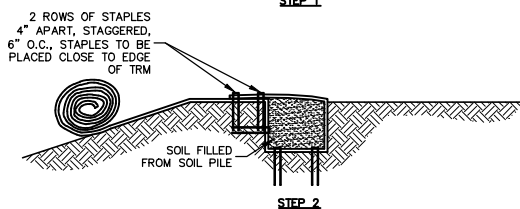
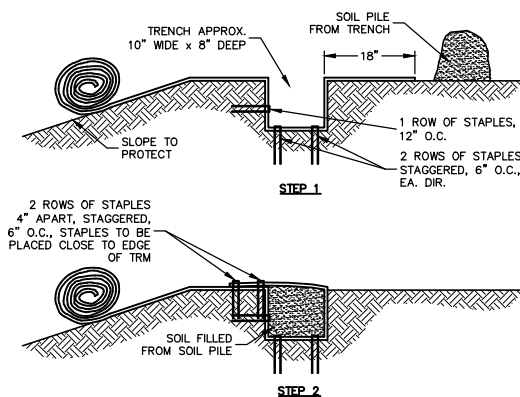
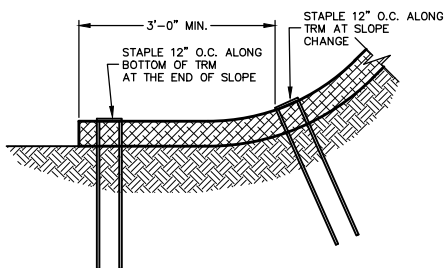
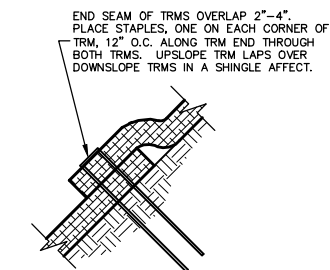

**SLOPE TRENCHING METHOD "B"**

NO SCALE

6  
5

### Recyclex® TRM Staple Pattern Guide

Application	Slope	
	≤ 3H:1V	≤ 5H:1V
Staple Pattern	A	B

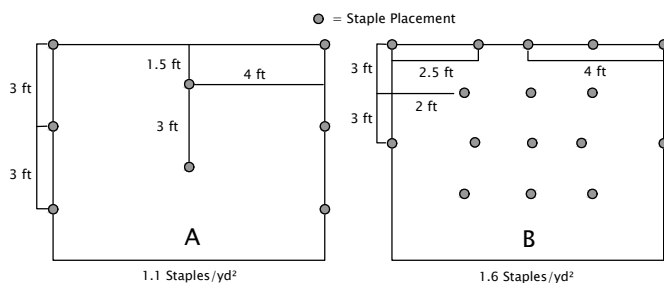

#### Notes:

1. For cohesive soil, use a minimum of a 6 in wire staple; for non-cohesive soil, use a minimum of a 8 in wire staple.
2. For best results, insert staples so heads are parallel to the flow of water.
3. For additional pull-out resistance, consider using TL-TA2 Gripple twist anchors for tough/cohesive soils or TL-TA1 Gripple twist anchors for moderate/non-cohesive soils.

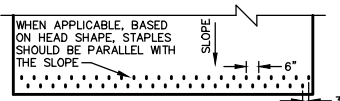

**BOTTOM OF SLOPE TERMINATION IF INSTALLATION 3' BEYOND TOE OF SLOPE IS NOT POSSIBLE**

NO SCALE

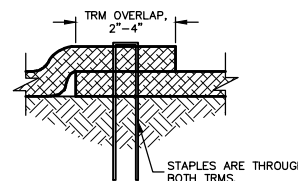

**American  
Excelsior  
Company®**  
Earth Science Division

**AMERICAN EXCELSIOR COMPANY**  
ARLINGTON, TEXAS

SHEET DESCRIPTION  
**RECYCLEX® TRM**  
SLOPE APPLICATION DETAIL

DATE 11/22/23  
SCALE  
NONE

DRAWN BY  
PROJECT NO.  
SHEET NO.  
5