

SLOPE DETAIL
NO SCALE (1/27)

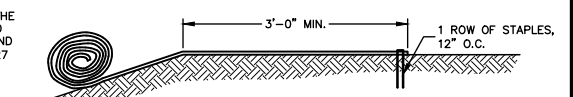

OVER SLOPE CREST METHOD
NO SCALE (4/27)

DO NOT NEED TO TRENCH BLANKET IF IT CAN BE EXTENDED A MINIMUM OF 3'-0" OVER THE CREST OF THE SLOPE.

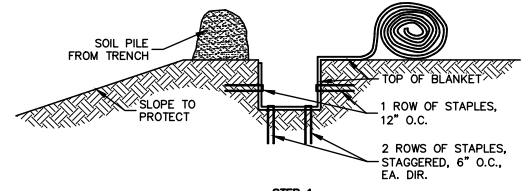

STEP 1

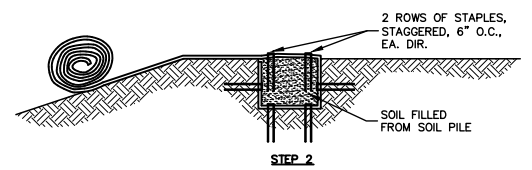

STEP 2

SLOPE TRENCHING METHOD "A"
NO SCALE (5/27)

END SEAM OF BLANKETS OVERLAP 2"-4". PLACE STAPLES, ONE ON EACH CORNER OF BLANKET, 12" O.C. ALONG BLANKET END THROUGH BOTH BLANKETS. UPSLOPE BLANKET LAPS OVER DOWNSLOPE BLANKETS IN A SHINGLE AFFECT.

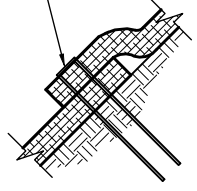

END ROLL OVERLAP
NO SCALE (2/27)

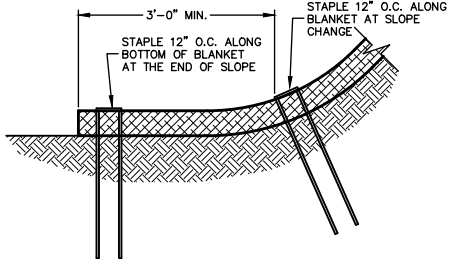

BOTTOM OF SLOPE TERMINATION
NO SCALE (3/27)

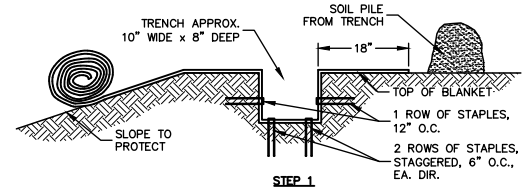

STEP 1

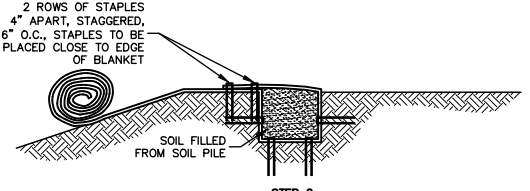

STEP 2

SLOPE TRENCHING METHOD "B"
NO SCALE (6/27)

Curlex® CL Staple Pattern Guide

For 8 ft wide Curlex CL Erosion Control Blankets
Adjust horizontal staple spacing for 4 ft and 16 ft wide Curlex CL Erosion Control Blankets

Application	Slope		
	≤ 4H:1V	≤ 3H:1V	≤ 1.5H:1V
Staple Pattern	A	B	C

○ = Staple Placement

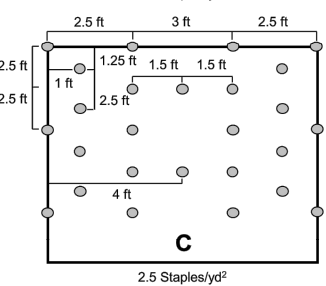
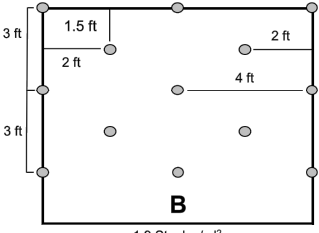
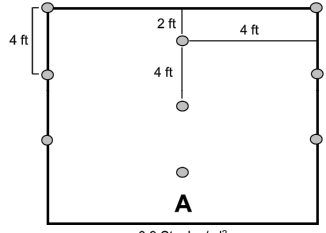

Notes:
1. Recommended staples are a minimum 4 in biodegradable E-Staple®, as provided by American Excelsior Company, or 6 in wire for cohesive soils and 6 in biodegradable E-Staple®, as provided by American Excelsior Company, or 8 in wire for non-cohesive soils.
2. For best results insert staples so heads are parallel to the flow of water.

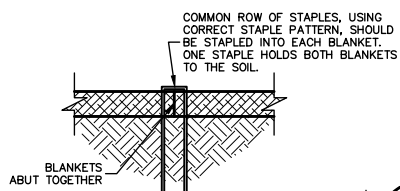

SIDE SEAM ABUT STAPLE DETAIL
NO SCALE (7/27)

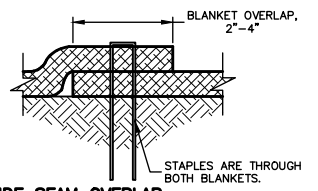

SIDE SEAM OVERLAP STAPLE DETAIL
NO SCALE (8/27)

