

**SLOPE DETAIL**  
NO SCALE

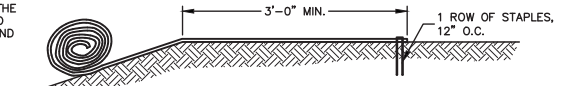

**OVER SLOPE CREST METHOD**  
NO SCALE

DO NOT NEED TO TRENCH BLANKET IN IF IT CAN BE EXTENDED A MINIMUM OF 3'-0" OVER THE CREST OF THE SLOPE.

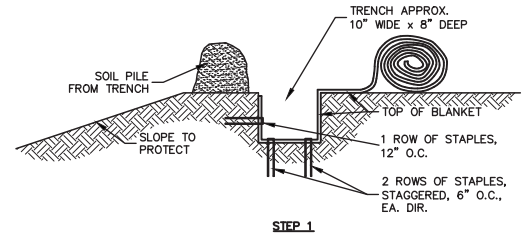

**STEP 1**

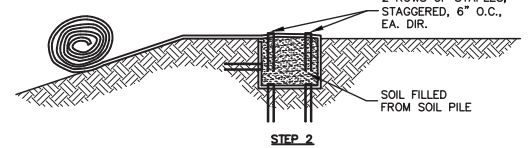

**STEP 2**

**SLOPE TRENCHING METHOD "A"**  
NO SCALE

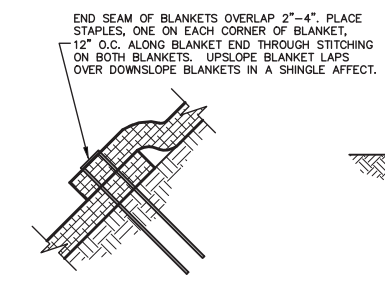

**END ROLL OVERLAP**  
NO SCALE

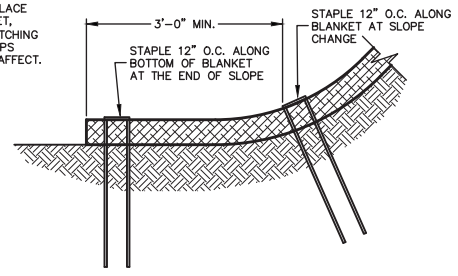

**BOTTOM OF SLOPE TERMINATION**  
NO SCALE

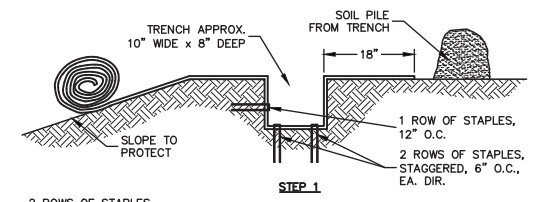

**STEP 1**

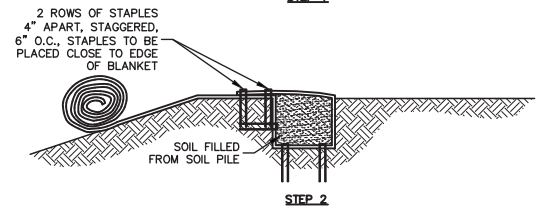

**STEP 2**

**SLOPE TRENCHING METHOD "B"**  
NO SCALE

**Curlex® NetFree™ Staple Pattern Guide**

Application	Slope	
	≤ 4H:1V	≤ 3H:1V
Staple Pattern	A	B

● = Staple Placement

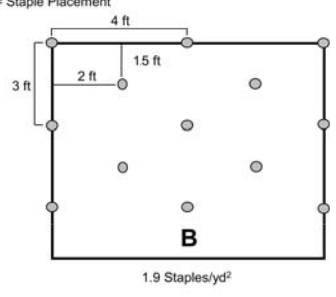
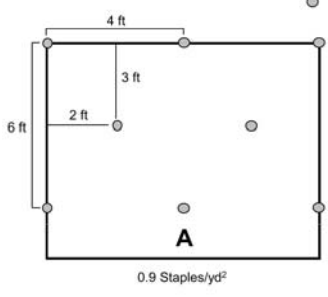

**Notes:**

1. Recommended staples are a minimum 4 in long 100% biodegradable E-Staple®, as provided by American Excelsior Company, for cohesive soils and 6 in long 100% biodegradable E-Staple®, as provided by American Excelsior Company, for non-cohesive soils.
2. Staples shall be placed on a stitch line and for best results insert staples so heads are parallel to the flow of water.

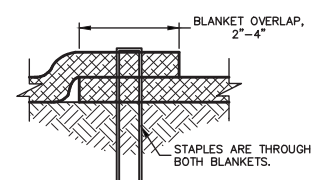

**SIDE SEAM OVERLAP STAPLE DETAIL**  
NO SCALE

