

**SLOPE DETAIL**  
NO SCALE

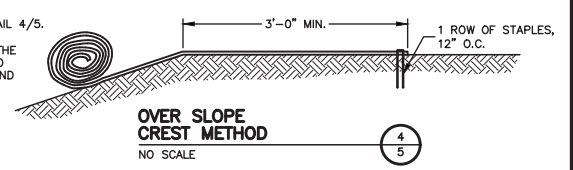

**OVER SLOPE CREST METHOD**  
NO SCALE

DO NOT NEED TO TRENCH TRM IN IF IT CAN BE EXTENDED A MINIMUM OF 3'-0" OVER THE CREST OF THE SLOPE.

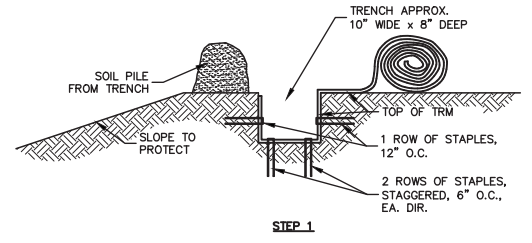

**STEP 1**

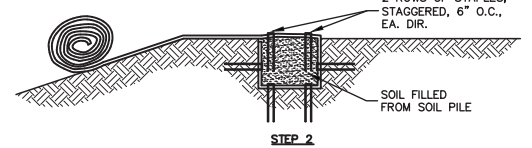

**STEP 2**

**SLOPE TRENCHING METHOD "A"**  
NO SCALE

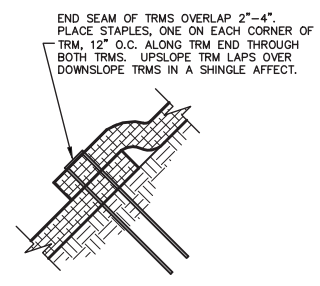

**END ROLL OVERLAP**  
NO SCALE

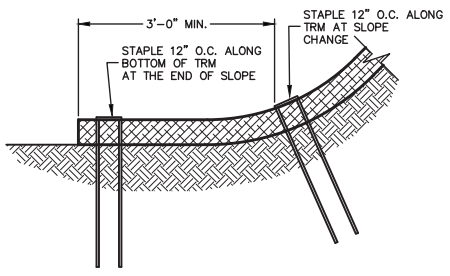

**BOTTOM OF SLOPE TERMINATION**  
NO SCALE

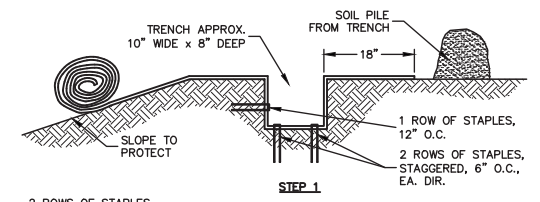

**STEP 1**

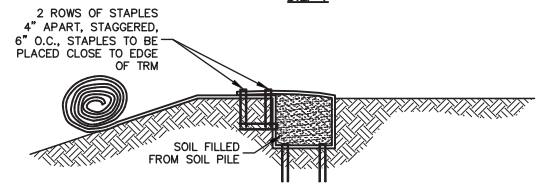

**STEP 2**

**SLOPE TRENCHING METHOD "B"**  
NO SCALE

**Recyclex® TRM Staple Pattern Guide**

Application	Slope	
	≤ 3H:1V	≤ .5H:1V
Staple Pattern	A	B

● = Staple Placement

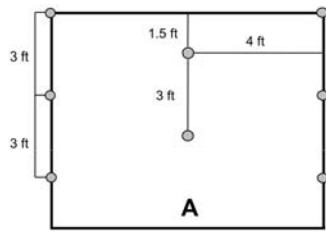

1.1 Staples/yd<sup>2</sup>

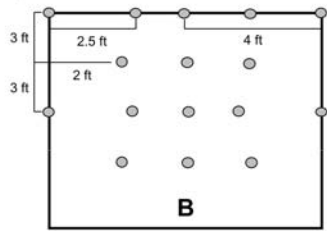

1.6 Staples/yd<sup>2</sup>

**Notes:**

1. For cohesive soil use a 6 in wire staple and for non-cohesive soil use an 8 in wire staple.
2. For best results insert staples so heads are parallel to the flow of water.

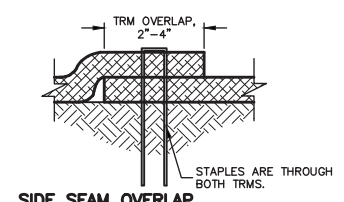

**SIDE SEAM OVERLAP STAPLE DETAIL**  
NO SCALE