

SLOPE DETAIL
NO SCALE

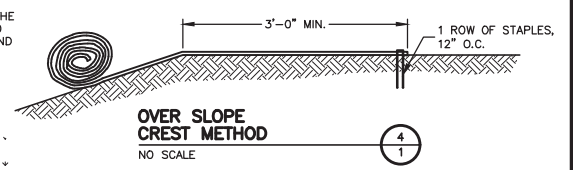

OVER SLOPE CREST METHOD
NO SCALE

DO NOT NEED TO TRENCH BLANKET IF IT CAN BE EXTENDED A MINIMUM OF 3'-0" OVER THE CREST OF THE SLOPE.

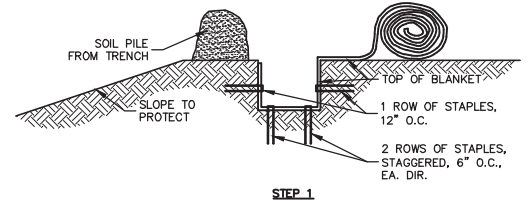

STEP 1

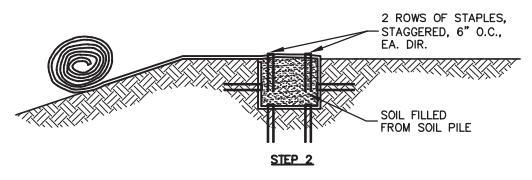

STEP 2

SLOPE TRENCHING METHOD "A"
NO SCALE

END SEAM OF BLANKETS OVERLAP 2"-4". PLACE STAPLES, ONE ON EACH CORNER OF BLANKET, 12" O.C. ALONG BLANKET END THROUGH BOTH BLANKETS. UPSLOPE BLANKET LAPS OVER DOWNSLOPE BLANKETS IN A SHINGLE AFFECT.

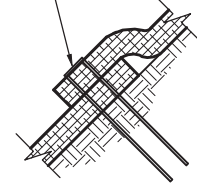

END ROLL OVERLAP
NO SCALE

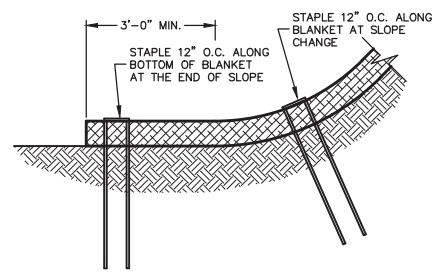

BOTTOM OF SLOPE TERMINATION
NO SCALE

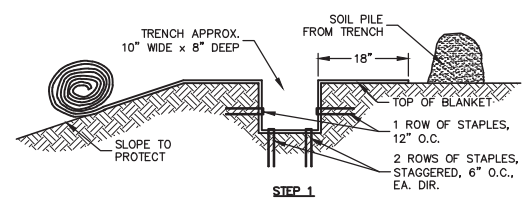

STEP 1

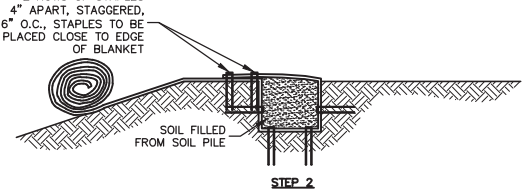

STEP 2

SLOPE TRENCHING METHOD "B"
NO SCALE

TriNet® Curlex® Turf Reinforcement Mat (TRM) Staple Pattern Guide

For 8 ft wide TriNet TRM
Adjust horizontal staple spacing for 16ft wide TRM

Application	Slope	
	≤ 3H:1V	≤ .5H:1V
Staple Pattern	A	B

● = Staple Placement

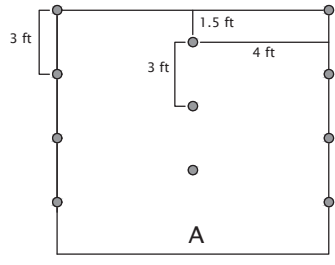

1.2 Staples/yd²

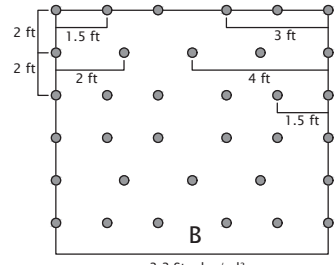

3.3 Staples/yd²

Notes:

1. For cohesive soil use a 6 in wire staple and for non-cohesive soil use an 8 in wire staple.
2. For best results insert staples so heads are parallel to the flow of water.

COMMON ROW OF STAPLES, USING CORRECT STAPLE PATTERN, SHOULD BE STAPLED INTO EACH BLANKET. ONE STAPLE HOLDS BOTH BLANKETS TO THE SOIL.

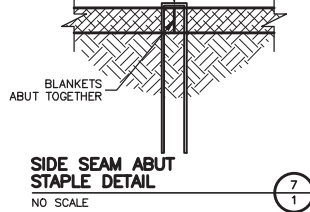

SIDE SEAM ABUT STAPLE DETAIL
NO SCALE

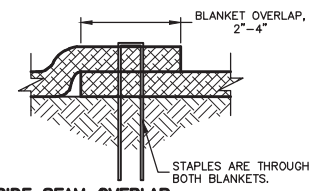

SIDE SEAM OVERLAP STAPLE DETAIL
NO SCALE