

SLOPE DETAIL
NO SCALE (1/27)

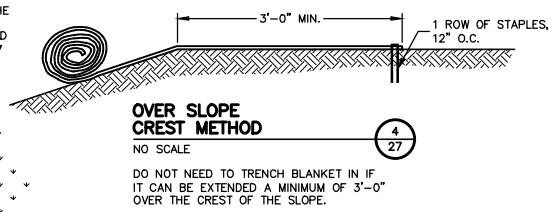

OVER SLOPE CREST METHOD
NO SCALE (4/27)
DO NOT NEED TO TRENCH BLANKET IN IF IT CAN BE EXTENDED A MINIMUM OF 3'-0\"/>

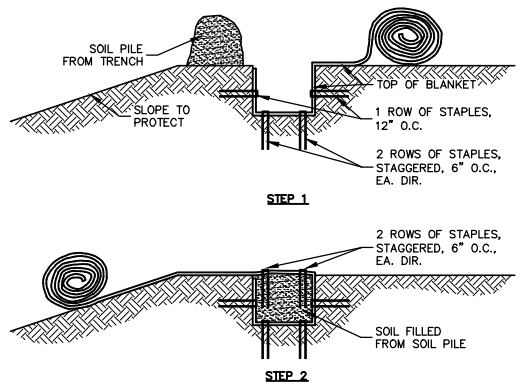

SLOPE TRENCHING METHOD "A"
NO SCALE (5/27)

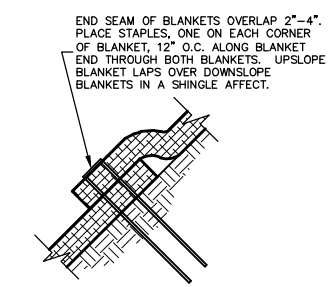

END ROLL OVERLAP
NO SCALE (2/27)

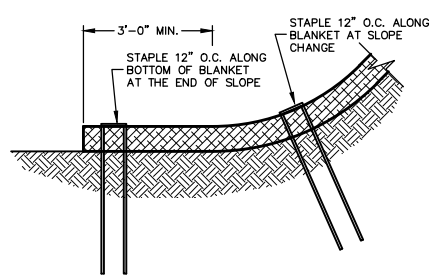

BOTTOM OF SLOPE TERMINATION IF INSTALLED 3' BEYOND THE TOE OF SLOPE
NO SCALE (3/27)

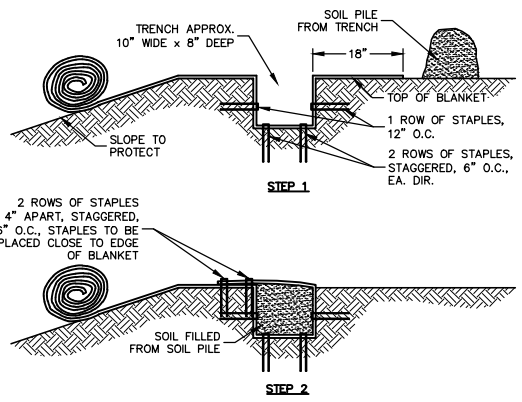

SLOPE TRENCHING METHOD "B"
NO SCALE (6/27)

Curlex® CL Staple Pattern Guide

For 8 ft wide Curlex CL Erosion Control Blankets
Adjust horizontal staple spacing for 4ft and 16 ft wide Curlex Erosion Control Blankets

Application	Slope		
	≤ 4H:1V	≤ 3H:1V	≤ 1.5H:1V
Staple Pattern	A	B	C

● = Staple Placement

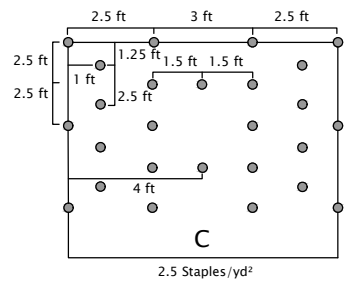
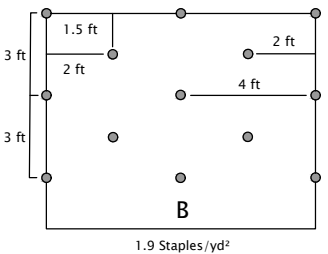
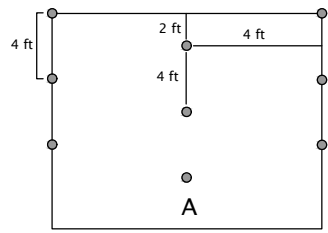

Notes:

1. Recommended staples are minimum 4 in biodegradable E-Staple®, as provided by American Excelsior Company, or 6 in wire for cohesive soils and 6 in biodegradable E-staple®, as provided by American Excelsior Company, or 8 in wire for non-cohesive soils.
2. For best results, insert staples so heads are parallel to the flow of water.
3. For additional pull-out resistance, consider using TL-TA2 Gripple twist anchors for tough/cohesive soils or TL-TA1 Gripple twist anchors for moderate/non-cohesive soils.
4. Adjust staple pattern so staples are placed in critical slope points (e.g. slope change)

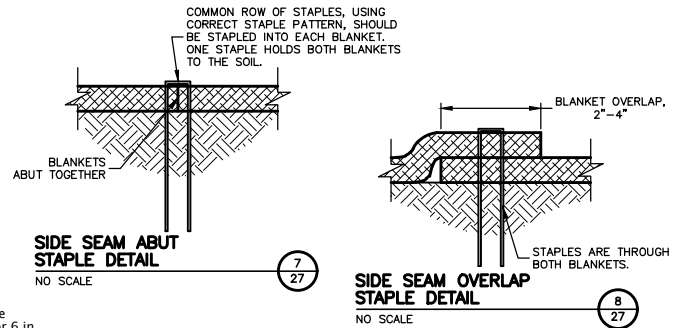

SIDE SEAM ABUT STAPLE DETAIL
NO SCALE (7/27)

SIDE SEAM OVERLAP STAPLE DETAIL
NO SCALE (8/27)

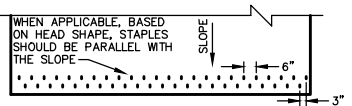

BOTTOM OF SLOPE TERMINATION IF INSTALLATION 3' BEYOND TOE OF SLOPE IS NOT POSSIBLE
NO SCALE (9/27)

