

NOTES:
1. SEE RECYCLEX® SLOPE APPLICATION DETAIL SHEET FOR PROPER SLOPE INSTALLATION.

CHANNEL DETAIL
NO SCALE

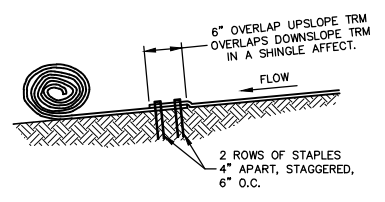
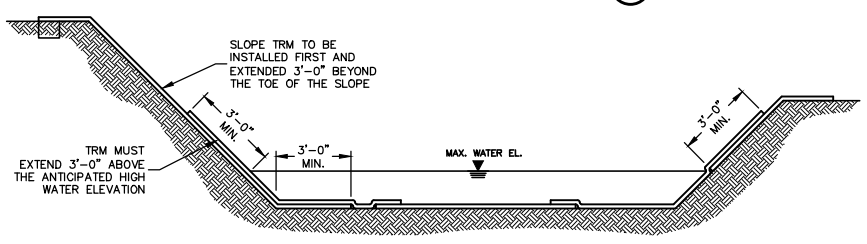
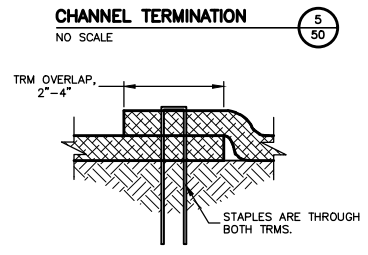
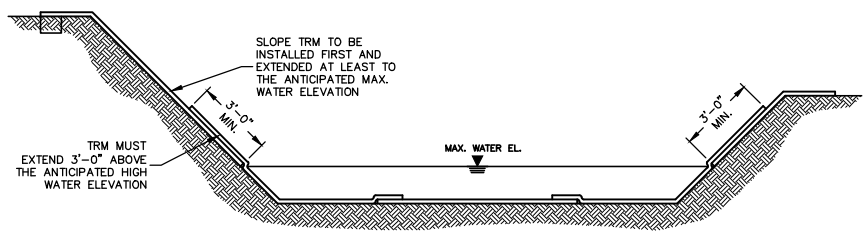
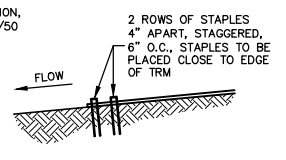

Curlex® Enforcer® Staple Pattern Guide

For 8 ft wide Curlex Erosion Control Blankets
Adjust horizontal staple spacing for 4 ft and 16 ft wide Curlex Erosion Control Blankets

Application	Channel
Staple Pattern	≤ 10.0 lb/ft ² (480 Pa) Shear Stress ≤ 17 ft/sec (5.2 m/sec) Velocity C

● = Staple Placement

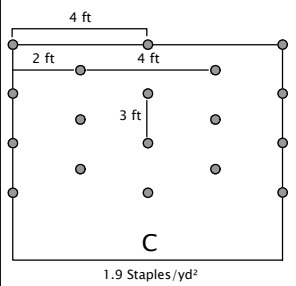

- Notes:**
1. Recommended staples are minimum 4 in biodegradable E-Staple®, as provided by American Excelsior Company, or 6 in wire for cohesive soils and 6 in biodegradable E-staple®, as provided by American Excelsior Company, or 8 in wire for non-cohesive soils.
 2. For best results insert staples so heads are parallel to the flow of water.
 3. For additional pull-out resistance, consider using TL-TA2 Gripple twist anchors for tough/cohesive soils or TL-TA1 Gripple twist anchors for moderate/non-cohesive soils.
 4. Adjust staple pattern so staples are placed in critical channel points (e.g. slope interface, channel bottom) as illustrated below:

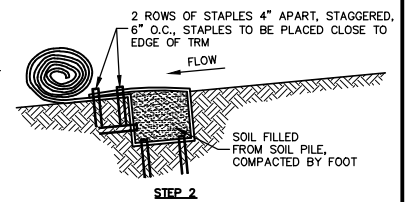
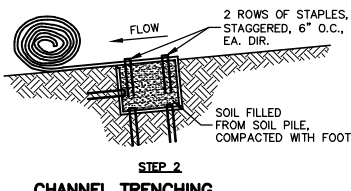
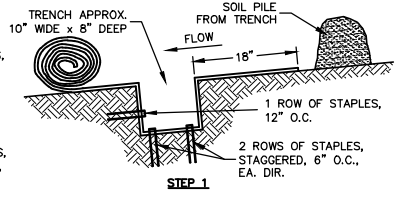
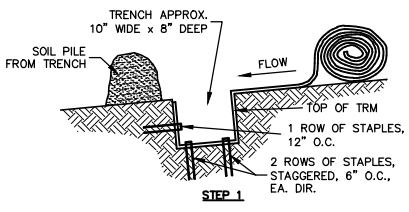
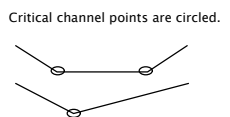

CHANNEL TRENCHING METHOD "A"
NO SCALE

CHANNEL TRENCHING METHOD "B"
NO SCALE

AMERICAN EXCELSIOR COMPANY
ARLINGTON, TEXAS

SHEET DESCRIPTION
CURLEX® ENFORCER® TRM CHANNEL APPLICATION DETAIL

DATE 06/03/24	DRAWN BY	
SCALE	PROJECT NO.	SHEET NO.
NONE		50

