

CURLEX<sup>®</sup> HI-VIS EXCELSIOR LOG<sup>™</sup>  
DOUBLED STACKED PROTECTION  
NO SCALE 1  
46

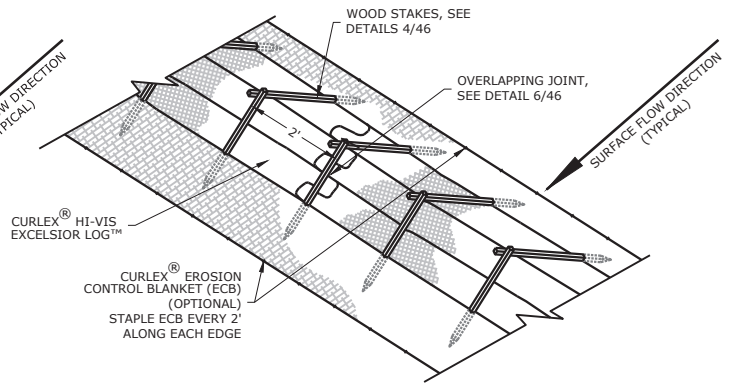

CURLEX<sup>®</sup> HI-VIS EXCELSIOR LOG<sup>™</sup>  
TRIPLE STACKED PROTECTION  
NO SCALE 2  
46

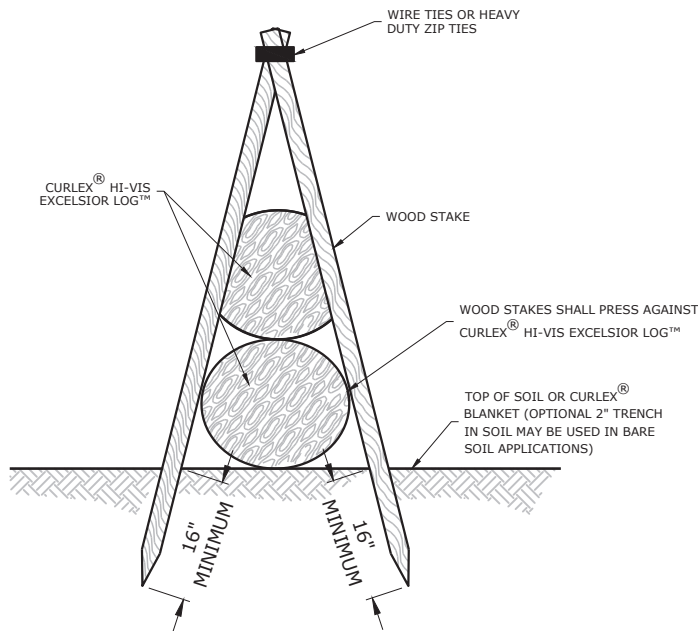

WOODEN STAKES  
DOUBLE STACKED INSTALLATION  
NO SCALE 3  
46

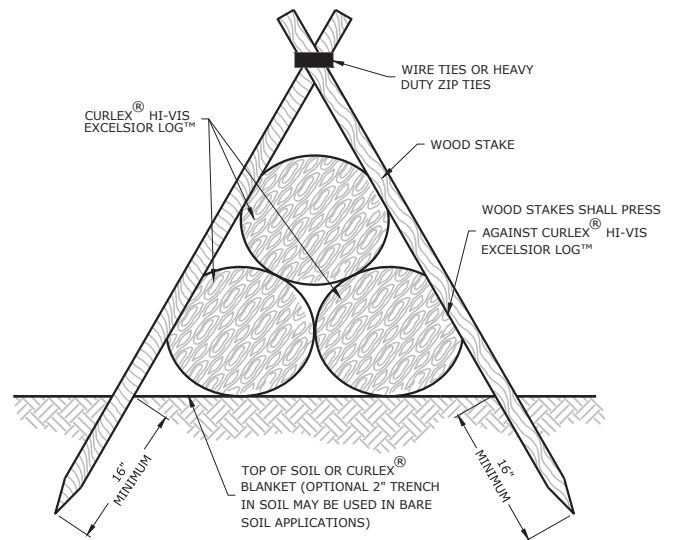

WOODEN STAKES  
TRIPLE STACKED INSTALLATION  
NO SCALE 4  
46

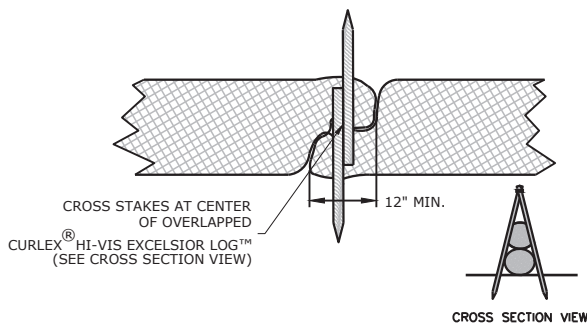

ANCHOR DETAIL (PLAN VIEW)  
OVERLAPPING JOINT  
NO SCALE 5  
46

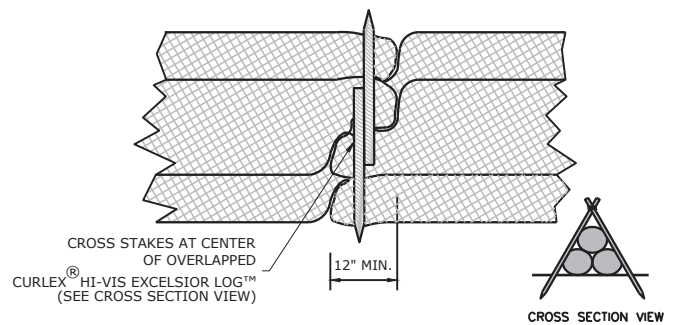

ANCHOR DETAIL (PLAN VIEW)  
OVERLAPPING JOINT  
NO SCALE 6  
46

NOTES:

1. RECOMMENDED WOODEN STAKES ARE 1 1/8" X 1 1/8" X 30" FOR 9" CURLEX<sup>®</sup> HI-VIS EXCELSIOR LOG<sup>™</sup> (DOUBLED STACKED).
2. RECOMMENDED WOODEN STAKES ARE 1 1/8" X 1 1/8" X 48" FOR 9" CURLEX<sup>®</sup> HI-VIS EXCELSIOR LOG<sup>™</sup> (TRIPLE STACKED).