

SLOPE DETAIL
NO SCALE (1/5)

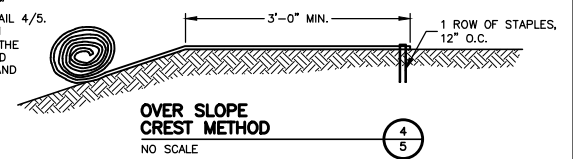

OVER SLOPE CREST METHOD
NO SCALE (4/5)

DO NOT NEED TO TRENCH TRM IN IF IT CAN BE EXTENDED A MINIMUM OF 3'-0" OVER THE CREST OF THE SLOPE.

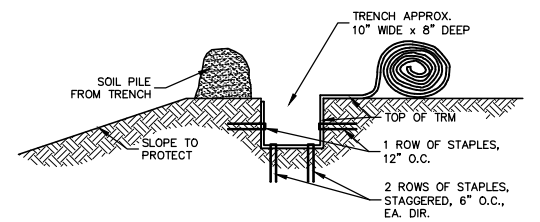

STEP 1

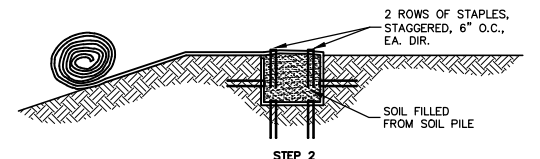

STEP 2

SLOPE TRENCHING METHOD "A"
NO SCALE (5/5)

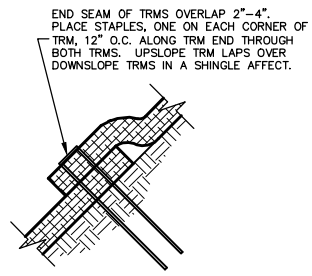

END ROLL OVERLAP
NO SCALE (2/5)

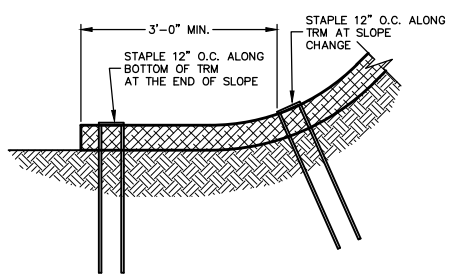

BOTTOM OF SLOPE TERMINATION IF INSTALLED 3' BEYOND THE TOE OF SLOPE
NO SCALE (3/5)

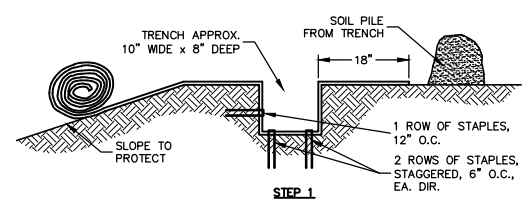

STEP 1

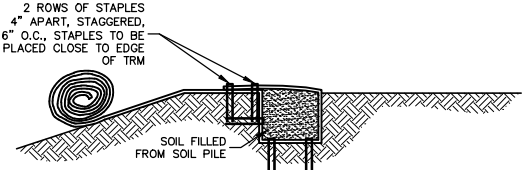

STEP 2

SLOPE TRENCHING METHOD "B"
NO SCALE (6/5)

Recyclex® TRM Staple Pattern Guide

Application	Slope	
	≤ 3H:1V	≤ 5H:1V
Staple Pattern	A	B

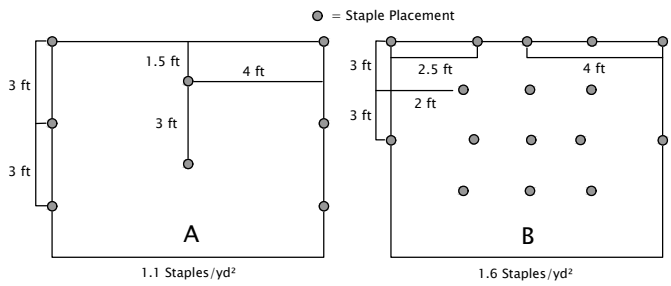

Notes:

1. For cohesive soil, use a minimum of a 6 in wire staple; for non-cohesive soil, use a minimum of a 8 in wire staple.
2. For best results, insert staples so heads are parallel to the flow of water.
3. For additional pull-out resistance, consider using TL-TA2 Gripple twist anchors for tough/cohesive soils or TL-TA1 Gripple twist anchors for moderate/non-cohesive soils.
4. Adjust staple pattern so staples are placed in critical slope points (e.g. slope change)

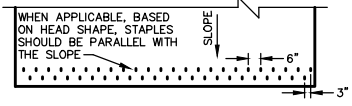

BOTTOM OF SLOPE TERMINATION IF INSTALLATION 3' BEYOND TOE OF SLOPE IS NOT POSSIBLE
NO SCALE (8/5)

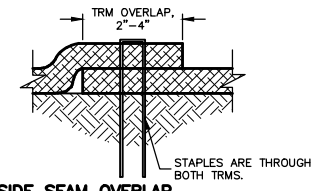

SIDE SEAM OVERLAP STAPLE DETAIL
NO SCALE (7/5)

