

CURLEX® HI-VIS EXCELSIOR LOG™ DETAIL (NO BLANKET)
NO SCALE

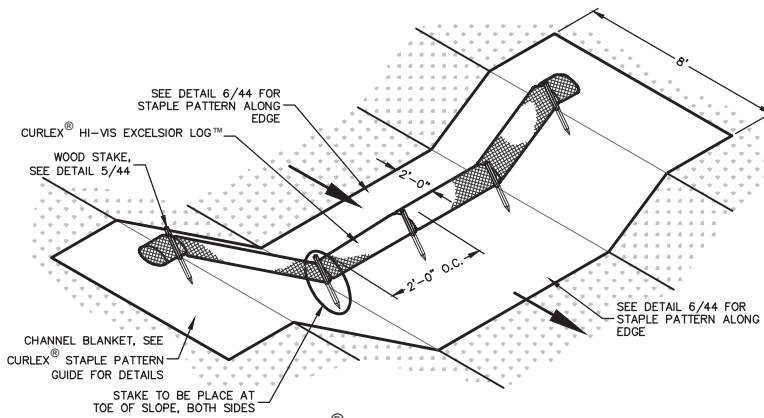

CURLEX® HI-VIS EXCELSIOR LOG™ DETAIL (WITH BLANKET)
NO SCALE

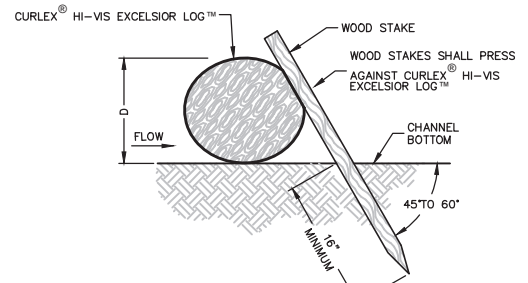

STAKE DETAILS (NO TRENCH)
NO SCALE

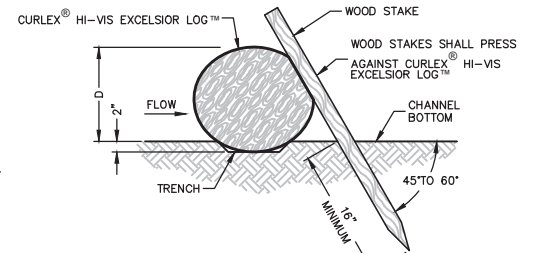

STAKE DETAIL (WITH TRENCH)
NO SCALE

NOTE: TRENCH OPTION IS MOST APPLICABLE IN LOOSE, UNCONSOLIDATED SOILS

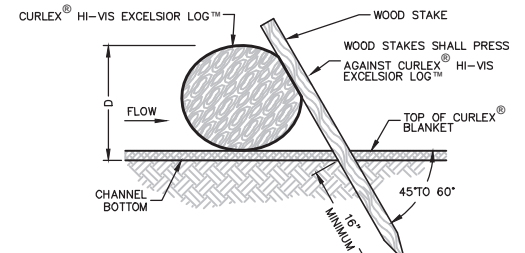

STAKE DETAILS (NO TRENCH)
NO SCALE

NOTES:

1. TRENCH OPTION IS MOST APPLICABLE IN LOOSE, UNCONSOLIDATED SOILS.
2. RECOMMENDED WOODEN STAKES ARE 1 1/8" X 1 1/8" X 30" FOR 9" CURLEX® HI-VIS EXCELSIOR LOG™.
3. CURLEX® HI-VIS EXCELSIOR LOG™ SHALL BE OVERLAPPED IN CHANNELS REQUIRING MORE THAN ONE UNIT ACROSS THE CHANNEL WIDTH (SEE DETAIL 7/44).
4. OVERLAPS SHALL NOT BE LOCATED IN CRITICAL AREAS SUCH AS CHANNEL CENTER, SIDE SLOPE CHANNEL BOTTOM INTERFACE, ETC.

9" Curlex® Hi-Vis Excelsior Log™ - Recommended Spacing in Channelized Flow Applications

Channel Gradient (%)	Spacing Between Products (ft)	
	9" Curlex	Hi-Vis Excelsior Log™
0.5	136.7	
1	68.3	
1.5	45.6	
2	34.2	
2.5	27.3	
3	22.8	
3.5	19.5	
4	17.1	
4.5	15.2	
5	13.7	
5.5	12.4	
6	11.4	
6.5	10.5	
7	9.8	
7.5	9.1	
8	8.5	
8.5	8.0	
9	7.6	
9.5	7.2	
10	6.8	
11	6.2	
12	5.7	
13	5.3	
14	4.9	
15	4.6	
16	4.3	
17	4.0	
18	3.8	
19	3.6	
20	3.4	
25	2.7	
30	2.3	
35	2.0	
40	1.7	
45	1.5	
50	1.4	

Notes:

1. Spacing of Curlex® Hi-Vis Excelsior Log™ is calculated by: $\frac{\text{Distance between channel bottom and top of installed Curlex® Hi-Vis Excelsior Log™ (ft)}}{\text{Channel gradient (\%)}} \times 100 = \text{Curlex® Hi-Vis Excelsior Log™ (ft)}$
2. Minimum installed heights used for determining spacing values in table. Minimum installed height of 9 in Curlex® Hi-Vis Excelsior Log™ is 8.2 in.

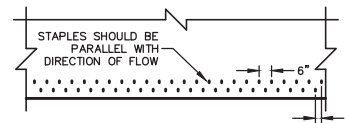

CHANNEL TERMINATION PLAN
NO SCALE

$$\left[\frac{\text{DISTANCE BETWEEN CHANNEL BOTTOM AND TOP OF INSTALLED CURLEX® HI-VIS EXCELSIOR LOG™ (D)(ft)}}{\text{CHANNEL GRADIENT (\%)}} \right] \times 100 = \text{CURLEX® HI-VIS EXCELSIOR LOG™ SPACING (ft)}$$

RECOMMENDED PLACEMENT INTERVAL BETWEEN CURLEX® HI-VIS EXCELSIOR LOG™

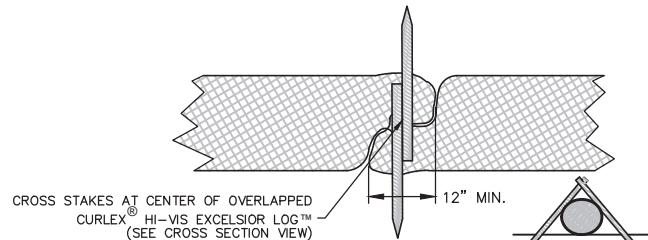

ANCHOR DETAIL (PLAN VIEW) OVERLAPPING JOINT
NO SCALE

